

TACHIKAWA
STAGE
GARDEN

A New Entertainment Venue Where the Sky, Earth and People Unite



TACHIKAWA STAGE GARDEN is a ground-up, state-of-the-art entertainment venue with a maximum capacity of 2,500 persons when seated, and 3,000 when standing, making it the largest in the Tama district of western Metro Tokyo. Designed with a nearly unlimited potential for flexibility, the facility is able to host concerts and live shows of all genres, from Pop, Rock, EDM, Classical, Anime Songs, as well as Music Festivals and Traditional Performing Arts. The magic of entertainment is that it takes only a single moment to move us and change our lives forever. TACHIKAWA STAGE GARDEN is conceived with the idea of creating a place where that magic becomes part of our everyday lives, a place where the next-generation of music lovers are raised and nurtured.

The facility is designed to make the unloading and set-up of equipment as easy as possible. It is fully equipped with a state-of-the-art PA system and speakers that enable performers to arrive with only their instruments and “plug and play” with a minimal loss of time. The orchestra level is designed with the upmost flexibility in mind. The seating can be completely removed, creating an all-standing pit for music concerts. It can also be configured with a platform stage or runways to accommodate a wide range of events. This flexibility can be further enhanced by utilizing the catwalks above to accommodate a wide range of lighting fixtures and flying systems. The most unique feature of the facility is the operable full-width wall at the rear of the mezzanine, which when fully opened, connects the interior space to an outdoor stage and amphitheater, with the lush gardens of GREEN SPRINGS as its backdrop.



FLOOR MAP

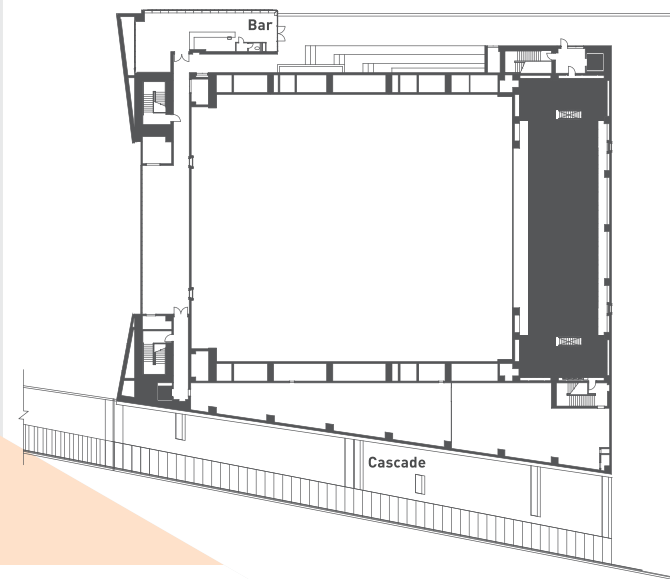

4F

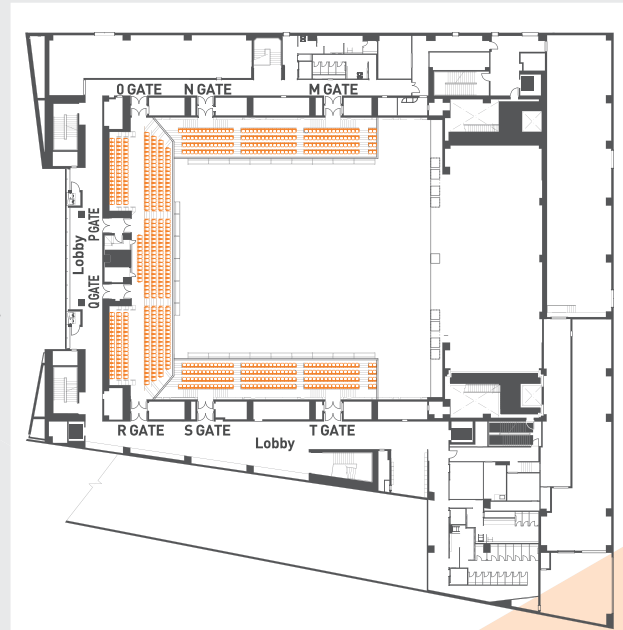

3F

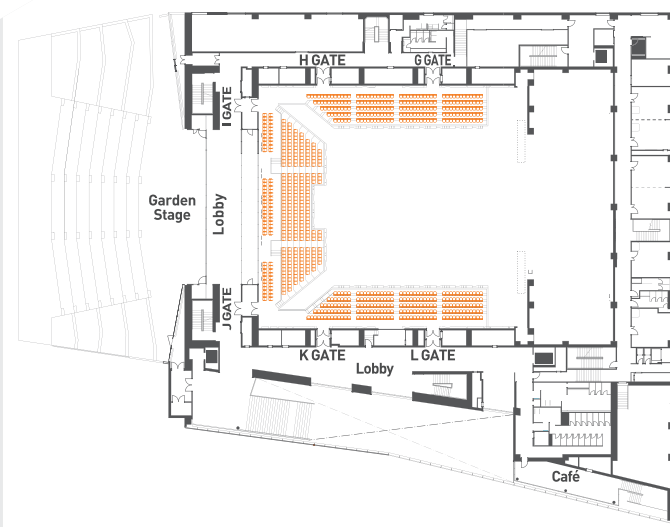

2F

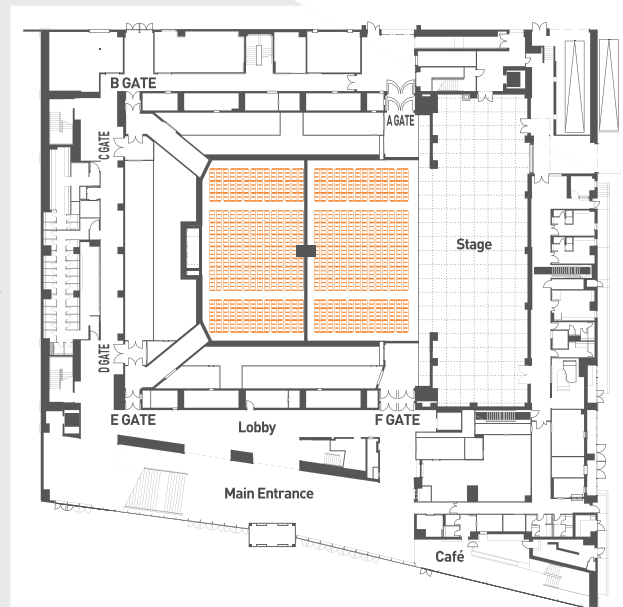

1F

House Maximum Capacity 3,018
Orchestra (1st Floor) : 1,008 seats or 1,500 all-standing
Mezzanine (2nd Floor) : 754 seats or 678 seats +154 standing
Balcony (3rd Floor) : 686 seats (no standing room)

Garden Stage (Outdoor Stage) Approximately 580m² (approx. 6243 ft²)

Backstage 1st Floor : 2 small dressing rooms, 1 medium dressing room, production room, dressing room lobby space
2nd Floor : 2 medium dressing rooms, 2 large dressing rooms, lounge, shower rooms, laundry room, smoking room

LAYOUT -Examples-

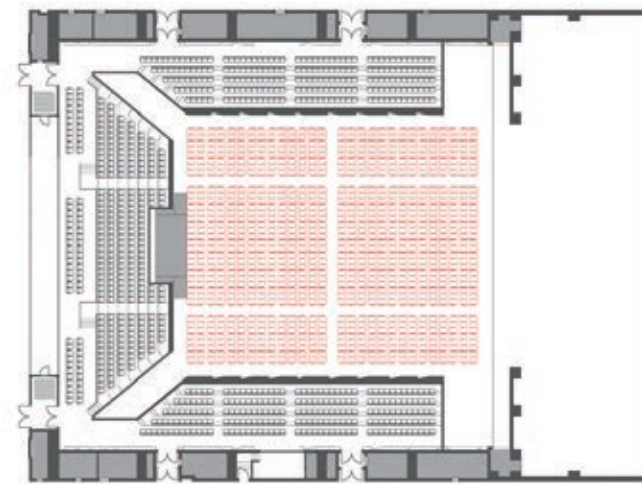

Theater Layout 1

Balcony (3rd Floor) : 686 seats
Mezzanine (2nd Floor) : 754 seats
Orchestra (1st Floor) : 1,008 seats
Total 2,448 seats

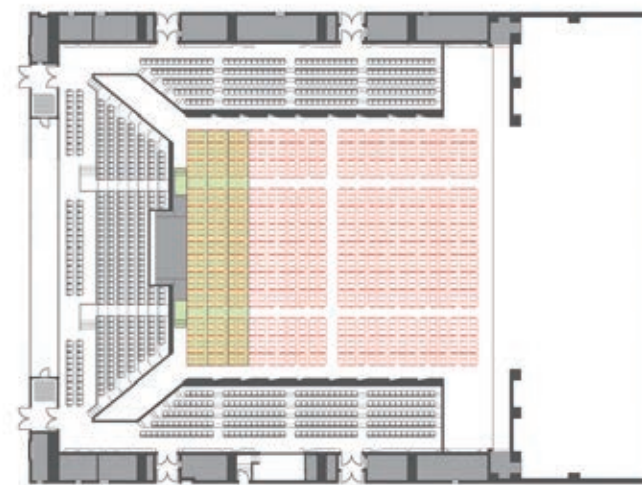

Theater Layout 2 (with rear-area seating risers)

Balcony (3rd Floor) : 686 seats
Mezzanine (2nd Floor) : 754 seats
Orchestra (1st Floor) : 1,008 seats
Total 2,448 seats

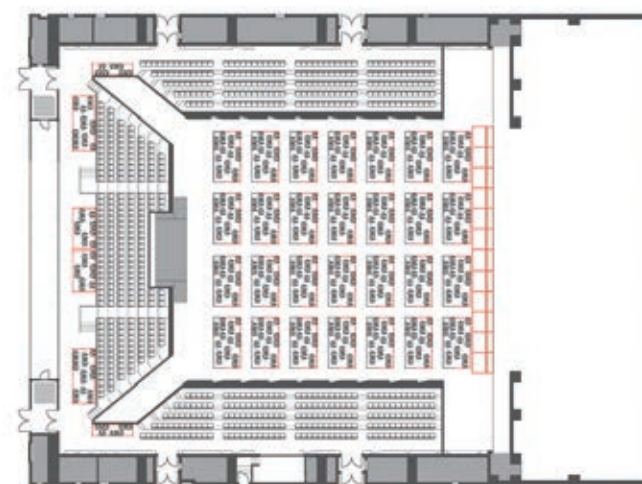

Standing Layout (1st Floor Orchestra and 2nd Floor Mezzanine)

Balcony (3rd Floor) : 686 seats
Mezzanine (2nd Floor) : 678 seats
154 standing
Orchestra (1st Floor) : 1,500 standing
Total 3,018 seats+standing

TECHNICAL



Front of House



NEXO STM Series speakers are permanently installed in the facility, providing a state-of-the-art acoustic environment. Mobile speaker batons that can accommodate user-provided tour equipment are also available. The control booth is located at the rear of the orchestra seats and positioned as to not obstruct any spectators' line of sight. The mobile lighting control system is halogen and LED compatible, and engineered to be expandable as needed.

VENUE SEATS



Celebrating the first installation in Japan, the orchestra level features the Matrix System (removable seating system) famously used at the Royal Albert Hall in London. The seating at the mezzanine and balcony levels are TACHIKAWA STAGE GARDEN Originals, custom-designed to assure a long and comfortable experience at any posture while maintaining good sight lines to the center and ends of the stage.

LOADING - UNLOADING DOCK / PARKING



Backstage Door



House Load-In Door

The loading area is configured so that 2 heavy-duty 11-ton trucks can load/unload simultaneously, with the loading dock being the same level as the stage. An additional truck can enter and park in the House Stage Left area, making it possible to accommodate a total of 3 heavy-duty trucks at the same time. This level of accessibility aims to reduce set-up and striking time.

LOUNGE

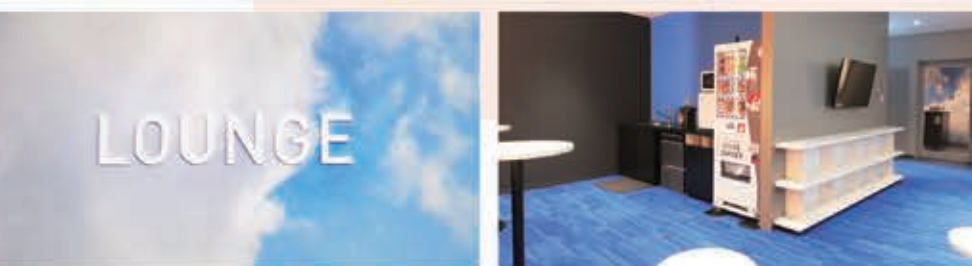

Following the blue carpet at the backstage area on the 2nd floor, it leads to the Sky Lounge where performers and staff can assemble and take a break in a relaxed and comfortable setting, both before and after the show.



2nd Floor Large Dressing Room (2-2AB)



DRESSING ROOM



1st Floor Small Dressing Room (1-1)



2nd Floor Medium Dressing Room (2-3)

Dressing rooms are provided in 3 different sizes to accommodate a wide number of performers, staff and crew. The small dressing rooms are a perfect sanctuary for VIP's and special guests, complete with an en-suite restroom and shower. There is also a smoking room, an accessible restroom, shower rooms, a laundry room, free wi-fi and a multi-function printer.





ENTRANCE



GARDEN STAGE



The entrance lobby, lavished in natural timber, is designed to provide a grand and iconic environment that ushers visitors from the routine of everyday life to the uplifting magic of live entertainment. At the mezzanine level, a STEINWAY & SONS O-180 grand piano is open for anyone to play and enjoy, aiming to create a place where people can experience music anytime.

The south side features the Garden Stage, an outdoor stage and amphitheater seating of approximately 580m² that can be used as a separate venue or in tandem with the indoor stage by opening the operable walls behind the 2nd floor seats. This ability of uniting the interior space with the exterior environment is one of the unique and distinguishing features of TACHIKAWA STAGE GARDEN. The other is the 130m long cascading steps that rise from the central garden all the way up to the roof level, where an unobstructed panorama of Showa Kinen Park and Mount Fuji stands front and center.



Baby Changing Room



Both men's and women's restrooms are provided on every floor. The women's restrooms have separate entry and exits, allowing for smooth and efficient use during intermissions.

Café / BAR

NORTH LINK 1F 2F

Anchoring the north end of the entrance lobby is the all-day cafe that features artisanal coffees, fresh baked pastries and a broad cafe-style menu. The bustling atmosphere is perfect for a rendez-vous before a show or a quick break during intermissions. The space extends to a mezzanine level where a more relaxed and calm environment encourages co-working and creative meetings. Catering services to dressing rooms can also be provided with advanced notice.



THE DRAGONFLY BAR 4F

The reward at the end of the climb up the cascade is the Dragonfly Bar where dramatic birds eye views of Showa Kinen Park and Mount Fuji to the west, and the lush gardens of GREEN SPRINGS to the south are framed. As impressive as the views are, the star of the space is the Bosendorfer piano "DRAGONFLY", often referred to as the "Treasure of Vienna", commissioned specifically for TACHIKAWA STAGE GARDEN and available to play upon request. A highly selective lunch and dinner menu complements a comprehensive wine/spirits list and cocktail creations that celebrate local ingredients and seasonal flavors. Private/exclusive use of the space can be arranged with advanced notice.



NIGHT VIEW



The afterglow of the concert lingers beyond the walls and radiates warmth and peace to its surroundings.



Photo by Akito Goto

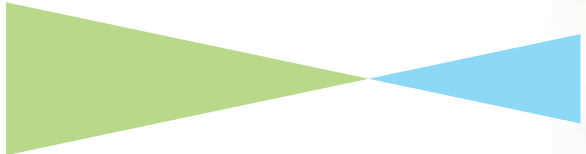

GREEN SPRINGS

WELL-BEING TOWN, where the sky, earth and people unite.

Located next to Showa Kinen Park, a new community is born where the principles of WELL-BEING strives beyond convenience and efficiency to provide comfort to the mind and body in our everyday lives.

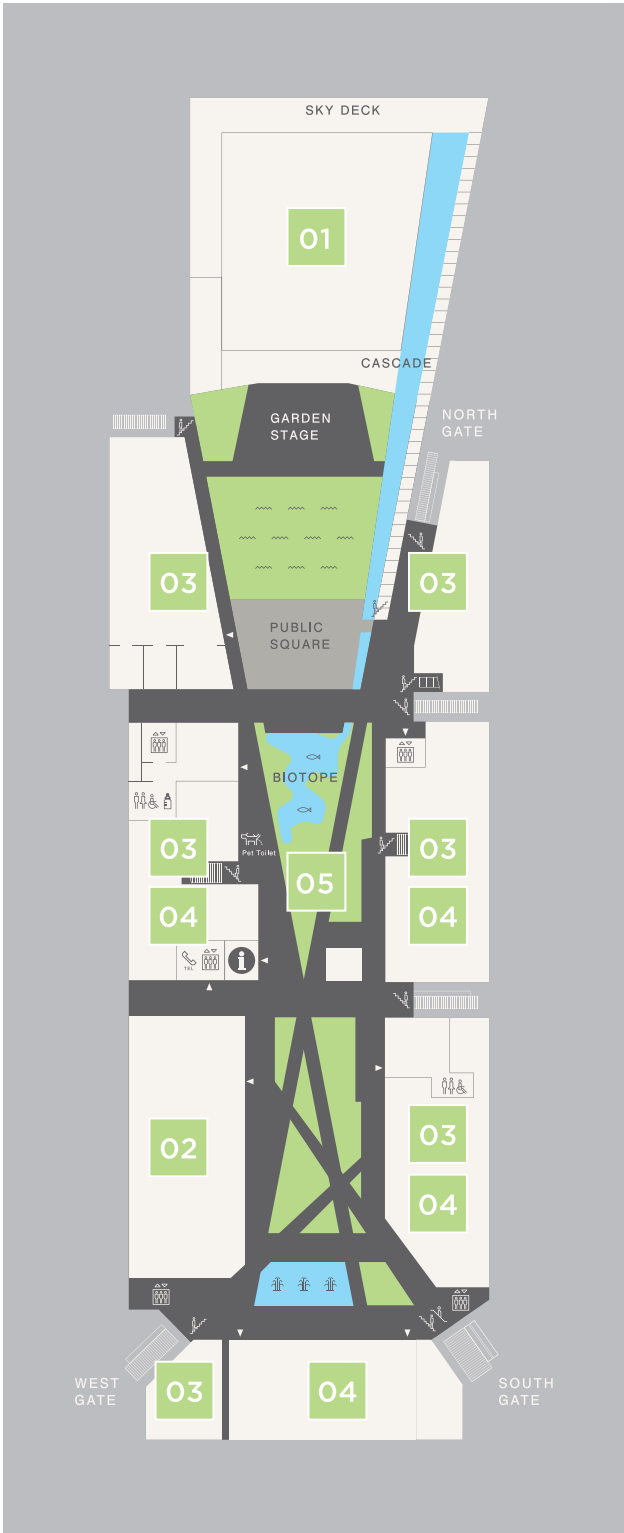

01

TACHIKAWA
STAGE
GARDEN



02

SORANO HOTEL

A paradise for the body and soul, the SORANO HOTEL features a rooftop infinity “onsen” (or heated) pool, restaurants with locally sourced seasonal menus, and guest rooms no smaller than 52㎡, each with a balcony facing Showa Kinen Park and the panorama to the west.



03

SHOPS &
RESTAURANTS

Nestled within the lush landscaped gardens are a collection of shops and restaurants that are mostly exclusive to GREEN SPRINGS, catering to a wide range of palettes and occasions. The generous number of outdoor benches, cafe seating and pergolas in the public space encourage a relaxed and casual take-out dining experience.



04

OFFICE

Forecasting the evolution of the modern workspace, each office space at GREEN SPRINGS is provided with its own exclusive balcony that face the inner garden, widening the spectrum of a creative and collaborative environment.



05

GARDEN

Anchoring GREEN SPRINGS is the lush central garden and public space that measure over 10,000㎡ in area. Its generous plazas, water features, walkways, kiosks and covered seating areas all combine to form the heart of the community where events, festivals and serendipity further connect the community to its natural environment.



ACCESS

Approximately 25 minutes from Shinjuku Sta. to Tachikawa Sta.
by JR (Japan Railway) Chuo Line (Chuo Special Express/Ome Special Express)
8 minutes on foot from JR Tachikawa Sta. North Exit
7 minutes on foot from Tachikawa-Kita Sta. (Tama Monorail)

① ATTENTION

Parking space is unavailable for visitors at TACHIKAWA STAGE GARDEN.
Please use public transportation.

▼ Venue Overview

Completion Date	March 2020
Client/Owner	Tachihi Holdings Co., Ltd.
Design	Yamashita Sekkei Inc.
Construction	Obayashi Corporation
Management	TACHIHI Education and Culture Association
Total Floor Area	12,142㎡ (approx. 130,695 ft²)
Maximum Capacity	3,018

TACHIKAWA STAGE GARDEN

N1, 3-3 Midori-cho, Tachikawa, Tokyo 190-0014 JAPAN

Venue Vicinity Map



<https://www.t-sg.jp>

